



EcoAccent RC271B

RS271B LED20/850 PSU-E MB WH

EcoAccent is the LED solution for shop lighting targeting energy savings. With a system efficacy of 95 lm/W in average, delivers more than 40% energy efficient compared to CDM solution. EcoAccent helps save energy and at the same time provides excellent lighting for retail environment thus enhancing the retail experience. The option of different light distribution for Accent light and variety of lumen packs and colour temperatures makes it an ideal solution for retail lighting.

Warnings and Safety

- To be used in Indoor Environment only

Product data

General Information		Power Factor (Min)	
Beam angle of light source	24°	0.9	
Light source color	850 neutral white	Controls and Dimming	
Driver included	Yes	Dimmable	No
Optic type	Beam angle 12 to 36°	Mechanical and Housing	
Optical cover/lens type	Aluminum and polycarbonate	Housing Material	Aluminum Alloy
Luminaire light beam spread	24°	Optic material	Aluminum and polycarbonate
Control interface	-	Optical cover/lens material	Polycarbonate
Protection class IEC	Safety class I (I)	Mounting device	MBA [Mounting bracket adjustable]
Flammability mark	F [For mounting on normally flammable surfaces]	Overall height	113 mm
Warranty period	3 years	Overall diameter	145 mm
Material	Aluminum	Color	White
Light source engine type	LED	Approval and Application	
Operating and Electrical		Ingress protection code	IP20 [Finger-protected]
Input Voltage	240 V	Mech. impact protection code	IK02 [0.2 J standard]
Input Frequency	50 Hz		

EcoAccent RC271B

Surge Protection (Common/Differential) 2.5 kV

Initial Performance (IEC Compliant)

Initial luminous flux (system flux)	2000 lm
Initial LED luminaire efficacy	100 lm/W
Init. Corr. Color Temperature	5000 K
Init. Color Rendering Index	>80
Initial input power	22 W
Power consumption tolerance	+/-10%

Over Time Performance (IEC Compliant)

Median useful life L70B50	40000 h
---------------------------	---------

Application Conditions

Ambient temperature range	0 to +45 °C
---------------------------	-------------

Product Data

Order product name	RS271B LED20/850 PSU-E MB WH
Order code	919515810950
Numerator - Quantity Per Pack	1
Numerator - Packs per outer box	1
Material Nr. (12NC)	919515810950
Net Weight (Piece)	0.900 kg



Dimensional drawing

Product: 301A-RECESSED
Type: RS271B
Application: Indoor

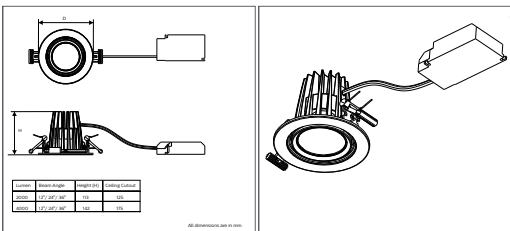

IN9002RDL - Downlights and spots

