



# Greenspace Flex

## RS378B P33 930 PSU-E MB M87

930 warm white - Electronic transformer - Gray

GreenSpace Flex is performance portfolio dedicated to Hospitality segment for GC/GM countries. With modular design concept, the light engines and different trims could have multiply of combination to satisfy diversified customer's requirement.

### Product data

General Information	
Light source color	930 warm white
Number of gear units	1 unit
Driver/power unit/transformer	ET [ Electronic transformer]
Driver included	Yes
Optical cover/lens type	Lens
Luminaire light beam spread	24°
Control interface	-
Connection	CE [ External connector]
Cable	-
Protection class IEC	Safety class II (II)
Glow-wire test	60030 [ Temperature 600 °C, duration 30 s]
CE mark	CE mark
Warranty period	3 years
Constant light output	No
Number of products on MCB of 16 A type B	40
EU RoHS compliant	Yes
Light source engine type	LED

### Operating and Electrical

Input Voltage	220 to 240 V
---------------	--------------

Input Frequency	50 to 60 Hz
Average CLO power consumption	2400 W
Power Factor (Min)	0.9

### Controls and Dimming

Dimmable	No
----------	----

### Mechanical and Housing

Housing Material	Aluminum
Optic material	Polymethyl methacrylate
Optical cover/lens material	Acrylate
Fixation material	Aluminum
Optical cover/lens finish	Textured
Overall length	0 mm
Overall width	0 mm
Overall height	107 mm
Overall diameter	87 mm
Color	Gray

### Approval and Application

Ingress protection code	IP20 [ Finger-protected]
-------------------------	--------------------------

## Greenspace Flex

Mech. impact protection code	IK04 [ 0.5 J standard plus]
------------------------------	-----------------------------

### Initial Performance (IEC Compliant)

Initial luminous flux (system flux)	2805 lm
Luminous flux tolerance	+/-10%
Initial LED luminaire efficacy	85 lm/W
Init. Corr. Color Temperature	3000 K
Init. Color Rendering Index	>90
Initial chromaticity	SDCM<3
Initial input power	33 W
Power consumption tolerance	+/-10%

### Over Time Performance (IEC Compliant)

Median useful life L80B50	50000 h
---------------------------	---------

### Application Conditions

Ambient temperature range	-20 to +45 °C
---------------------------	---------------

Maximum dim level	Not applicable
Suitable for random switching	No

### Product Data

Full product code	911401721562
Order product name	RS378B P33 930 PSU-E MB M87
Order code	911401721562
Numerator - Quantity Per Pack	1
Numerator - Packs per outer box	18
Material Nr. (12NC)	911401721562
Net Weight (Piece)	0.730 kg



## Dimensional drawing

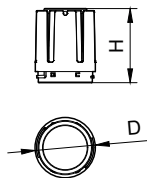

Modular Type	D, mm	H, mm
RS378B P6/P11 M55	55	49
RS378B P15 M55	55	49
RS378B P24 M70	70	90
RS378B P33 M87	87	107
RS378B P42 M102	102	116

### RS010 Spot RS010B-RS019B

