



Greenspace Flex

RS378B P15 927 PSU-E MB M55

927 warm white - Electronic transformer - Gray

GreenSpace Flex is performance portfolio dedicated to Hospitality segment for GC/GM countries. With modular design concept, the light engines and different trims could have multiply of combination to satisfy diversified customer's requirement.

Product data

| General Information | |
|--|--|
| Light source color | 927 warm white |
| Number of gear units | 1 unit |
| Driver/power unit/transformer | ET [Electronic transformer] |
| Driver included | Yes |
| Optical cover/lens type | Lens |
| Luminaire light beam spread | 30° |
| Control interface | - |
| Connection | CE [External connector] |
| Cable | - |
| Protection class IEC | Safety class II (II) |
| Glow-wire test | 60030 [Temperature 600 °C, duration 30 s] |
| CE mark | CE mark |
| Warranty period | 3 years |
| Constant light output | No |
| Number of products on MCB of 16 A type B | 40 |
| EU RoHS compliant | Yes |
| Light source engine type | LED |

Operating and Electrical

| | |
|---------------|--------------|
| Input Voltage | 220 to 240 V |
|---------------|--------------|

| | |
|-------------------------------|-------------|
| Input Frequency | 50 to 60 Hz |
| Average CLO power consumption | 960 W |
| Power Factor (Min) | 0.9 |

Controls and Dimming

| | |
|----------|----|
| Dimmable | No |
|----------|----|

Mechanical and Housing

| | |
|-----------------------------|-------------------------|
| Housing Material | Aluminum |
| Optic material | Polymethyl methacrylate |
| Optical cover/lens material | Acrylate |
| Fixation material | Aluminum |
| Optical cover/lens finish | Textured |
| Overall length | 0 mm |
| Overall width | 0 mm |
| Overall height | 72 mm |
| Overall diameter | 55 mm |
| Color | Gray |

Approval and Application

| | |
|-------------------------|--------------------------|
| Ingress protection code | IP20 [Finger-protected] |
|-------------------------|--------------------------|

Greenspace Flex

| | |
|------------------------------|-----------------------------|
| Mech. impact protection code | IK04 [0.5 J standard plus] |
|------------------------------|-----------------------------|

Initial Performance (IEC Compliant)

| | |
|-------------------------------------|---------|
| Initial luminous flux (system flux) | 1425 lm |
| Luminous flux tolerance | +/-10% |
| Initial LED luminaire efficacy | 95 lm/W |
| Init. Corr. Color Temperature | 2700 K |
| Init. Color Rendering Index | >90 |
| Initial chromaticity | SDCM<3 |
| Initial input power | 15 W |
| Power consumption tolerance | +/-10% |

Over Time Performance (IEC Compliant)

| | |
|---------------------------|---------|
| Median useful life L80B50 | 50000 h |
|---------------------------|---------|

Application Conditions

| | |
|---------------------------|---------------|
| Ambient temperature range | -20 to +45 °C |
|---------------------------|---------------|

| | |
|-------------------------------|----------------|
| Maximum dim level | Not applicable |
| Suitable for random switching | No |

Product Data

| | |
|---------------------------------|-----------------------------|
| Full product code | 911401721282 |
| Order product name | RS378B P15 927 PSU-E MB M55 |
| Order code | 911401721282 |
| Numerator - Quantity Per Pack | 1 |
| Numerator - Packs per outer box | 48 |
| Material Nr. (12NC) | 911401721282 |
| Net Weight (Piece) | 0.270 kg |



Dimensional drawing

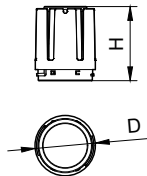

| Modular Type | D, mm | H, mm |
|-------------------|-------|-------|
| RS378B P6/P11 M55 | 55 | 49 |
| RS378B P15 M55 | 55 | 49 |
| RS378B P24 M70 | 70 | 90 |
| RS378B P33 M87 | 87 | 107 |
| RS378B P42 M102 | 102 | 116 |

RS010 Spot RS010B-RS019B

