



Greenspace Flex

RS378B P11 940 PSU-E MB M55

940 neutral white - Electronic transformer - Gray

GreenSpace Flex is performance portfolio dedicated to Hospitality segment for GC/GM countries. With modular design concept, the light engines and different trims could have multiply of combination to satisfy diversified customer's requirement.

Product data

General Information		Input Frequency	
Light source color	940 neutral white	Input Frequency	50 to 60 Hz
Number of gear units	1 unit	Average CLO power consumption	845 W
Driver/power unit/transformer	ET [Electronic transformer]	Power Factor (Min)	0.9
Driver included	Yes	Controls and Dimming	
Optical cover/lens type	Lens	Dimmable	No
Luminaire light beam spread	30°	Mechanical and Housing	
Control interface	-	Housing Material	Aluminum
Connection	CE [External connector]	Optic material	Polymethyl methacrylate
Cable	-	Optical cover/lens material	Acrylate
Protection class IEC	Safety class II (II)	Fixation material	Aluminum
Glow-wire test	60030 [Temperature 600 °C, duration 30 s]	Optical cover/lens finish	Textured
CE mark	CE mark	Overall length	0 mm
Warranty period	3 years	Overall width	0 mm
Constant light output	No	Overall height	49 mm
Number of products on MCB of 16 A type B	40	Overall diameter	55 mm
EU RoHS compliant	Yes	Color	Gray
Light source engine type	LED	Approval and Application	
Operating and Electrical		Ingress protection code	IP20 [Finger-protected]
Input Voltage	220 to 240 V		

Greenspace Flex

Mech. impact protection code	IK04 [0.5 J standard plus]
------------------------------	-----------------------------

Initial Performance (IEC Compliant)

Initial luminous flux (system flux)	1160 lm
Luminous flux tolerance	+/-10%
Initial LED luminaire efficacy	106 lm/W
Init. Corr. Color Temperature	4000 K
Init. Color Rendering Index	>90
Initial chromaticity	SDCM<3
Initial input power	11 W
Power consumption tolerance	+/-10%

Over Time Performance (IEC Compliant)

Median useful life L80B50	50000 h
---------------------------	---------

Application Conditions

Ambient temperature range	-20 to +45 °C
---------------------------	---------------

Maximum dim level	Not applicable
Suitable for random switching	No

Product Data

Full product code	911401721032
Order product name	RS378B P11 940 PSU-E MB M55
Order code	911401721032
Numerator - Quantity Per Pack	1
Numerator - Packs per outer box	48
Material Nr. (12NC)	911401721032
Net Weight (Piece)	0.190 kg



Dimensional drawing

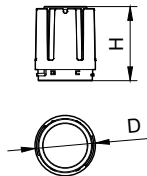

Modular Type	D, mm	H, mm
RS378B P6/P11 M55	55	49
RS378B P15 M55	55	49
RS378B P24 M70	70	90
RS378B P33 M87	87	107
RS378B P42 M102	102	116

RS010 Spot RS010B-RS019B

