



GreenSpace Flex

RS378B P6 940 PSU-E WB M55

- ° - 940 neutral white - Electronic transformer - Gray

GreenSpace Flex is performance portfolio dedicated to Hospitality segment for GC/GM countries. With modular design concept, the light engines and different trims could have multiply of combination to satisfy diversified customer's requirement.

Product data

General Information	
Beam angle of light source	- °
Light source color	940 neutral white
Number of gear units	1 unit
Driver/power unit/transformer	ET [Electronic transformer]
Driver included	Yes
Optic type	No [-]
Optical cover/lens type	Lens
Luminaire light beam spread	32°
Control interface	-
Connection	CE [External connector]
Cable	-
Protection class IEC	Safety class II (II)
Glow-wire test	60030 [Temperature 600 °C, duration 30 s]
Flammability mark	NO [-]
CE mark	CE mark
ENEC mark	-
Warranty period	3 years
Constant light output	No
Number of products on MCB of 16 A type B	-
EU RoHS compliant	Yes

Light source engine type	LED
Operating and Electrical	
Input Voltage	220 to 240 V
Input Frequency	50 to 60 Hz
Average CLO power consumption	470 W
Power Factor (Min)	0.5
Controls and Dimming	
Dimmable	No
Mechanical and Housing	
Housing Material	Aluminum
Reflector material	-
Optic material	Polymethyl methacrylate
Optical cover/lens material	Acrylate
Fixation material	Aluminum
Optical cover/lens finish	Textured
Overall length	0 mm
Overall width	0 mm
Overall height	49 mm

Greenspace Flex

Overall diameter	55 mm
Color	Gray

Approval and Application

Ingress protection code	IP20 [Finger-protected]
Mech. impact protection code	IK04 [0.5 J standard plus]

Initial Performance (IEC Compliant)

Initial luminous flux (system flux)	522 lm
Luminous flux tolerance	+/-10%
Initial LED luminaire efficacy	87 lm/W
Init. Corr. Color Temperature	4000 K
Init. Color Rendering Index	>90
Initial chromaticity	SDCM<3
Initial input power	6 W
Power consumption tolerance	+/-10%

Over Time Performance (IEC Compliant)

Median useful life L80B50	50000 h
---------------------------	---------

Application Conditions

Ambient temperature range	-20 to +45 °C
Maximum dim level	Not applicable
Suitable for random switching	No

Product Data

Full product code	911401720972
Order product name	RS378B P6 940 PSU-E WB M55
Order code	911401720972
Numerator - Quantity Per Pack	1
Numerator - Packs per outer box	36
Material Nr. (12NC)	911401720972
Net Weight (Piece)	0.180 kg



Dimensional drawing

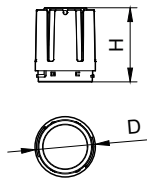

Modular Type	D, mm	H, mm
RS378B P6/P11 M55	55	49
RS378B P15 M55	55	49
RS378B P24 M70	70	90
RS378B P33 M87	87	107
RS378B P42 M102	102	116

RS010 Spot RS010B-RS019B

