



EcoAccent ST271T

ST271T LED40/850 PSU-E MB 1C WH

EcoAccent is the LED solution for shop targeting energy savings. With a system efficacy of 95 lm/W in average, delivering more than 40% energy efficient compared to CDM solution. EcoAccent helps save energy and at the same time provides excellent lighting for retail environment thus enhancing the retail experience. The option of different light distribution for Accent light and variety of lumen packs and colour temperatures makes it an ideal solution for retail lighting.

Warnings and Safety

- To be used in Indoor Environment only

Product data

General information		Power Factor (Min)	
Beam angle of light source	24 °	0.9	
Light source color	850 neutral white	Controls and dimming	
Driver included	Yes	Dimmable	No
Optic type	Beam angle 12 to 36°	Mechanical and housing	
Optical cover/lens type	Aluminum and polycarbonate	Housing Material	Aluminum Alloy
Luminaire light beam spread	24°	Optic material	Aluminum and polycarbonate
Control interface	-	Optical cover/lens material	Polycarbonate
Protection class IEC	Safety class II (II)	Mounting device	MBA [Mounting bracket adjustable]
Flammability mark	F [For mounting on normally flammable surfaces]	Overall width	163 mm
Warranty period	3 years	Overall height	225 mm
Material	Aluminum	Overall diameter	90 mm
Light source engine type	LED	Color	White
Operating and electrical		Approval and application	
Input Voltage	240 V	Ingress protection code	IP20 [Finger-protected]
Input Frequency	50 Hz	Mech. impact protection code	IK02 [0.2 J standard]

EcoAccent ST271T

Surge Protection (Common/Differential) 2.5 kV

Initial performance (IEC compliant)

Initial luminous flux (system flux)	4000 lm
Initial LED luminaire efficacy	100 lm/W
Init. Corr. Color Temperature	5000 K
Init. Color Rendering Index	>80
Initial input power	42 W
Power consumption tolerance	+/-10%

Over time performance (IEC compliant)

Median useful life L70B50	40000 h
---------------------------	---------

Application conditions

Ambient temperature range	0 to +45 °C
---------------------------	-------------

Product data

Order product name	ST271T LED40/850 PSU-E MB 1C WH
Order code	919515811229
Numerator - Quantity Per Pack	1
Numerator - Packs per outer box	1
Material Nr. (12NC)	919515811229
Net Weight (Piece)	0.900 kg



Dimensional drawing

Product: 1818 TRACK MOUNTED
Type: ST271T
Application: Indoor

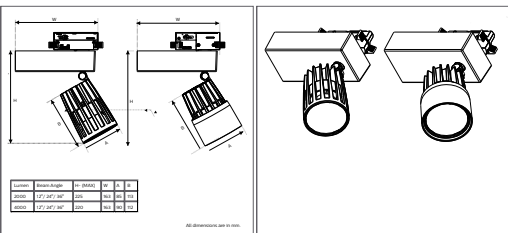

ST271T LED40/850 PSU-E MB 1C WH

