



EcoAccent RC271B

RS271B LED20/840 PSU-E NB WH

EcoAccent is the LED solution for shop lighting targeting energy savings. With a system efficacy of 95 lm/W in average, delivers more than 40% energy efficient compared to CDM solution. EcoAccent helps save energy and at the same time provides excellent lighting for retail environment thus enhancing the retail experience. The option of different light distribution for Accent light and variety of lumen packs and colour temperatures makes it an ideal solution for retail lighting.

Warnings and Safety

- To be used in Indoor Environment only

Product data

| General Information | | Power Factor (Min) | |
|-----------------------------|--|------------------------------|------------------------------------|
| Beam angle of light source | 12° | 0.9 | |
| Light source color | 840 neutral white | Controls and Dimming | |
| Driver included | Yes | Dimmable | No |
| Optic type | Beam angle 12 to 36° | Mechanical and Housing | |
| Optical cover/lens type | Aluminum and polycarbonate | Housing Material | Aluminum Alloy |
| Luminaire light beam spread | 12° | Optic material | Aluminum and polycarbonate |
| Control interface | - | Optical cover/lens material | Polycarbonate |
| Protection class IEC | Safety class I (I) | Mounting device | MBA [Mounting bracket adjustable] |
| Flammability mark | F [For mounting on normally flammable surfaces] | Overall height | 113 mm |
| Warranty period | 3 years | Overall diameter | 145 mm |
| Material | Aluminum | Color | White |
| Light source engine type | LED | Approval and Application | |
| Operating and Electrical | | Ingress protection code | IP20 [Finger-protected] |
| Input Voltage | 240 V | Mech. impact protection code | IK02 [0.2 J standard] |
| Input Frequency | 50 Hz | | |

EcoAccent RC271B

Surge Protection (Common/Differential) 2.5 kV

Initial Performance (IEC Compliant)

| | |
|-------------------------------------|----------|
| Initial luminous flux (system flux) | 2000 lm |
| Initial LED luminaire efficacy | 100 lm/W |
| Init. Corr. Color Temperature | 4000 K |
| Init. Color Rendering Index | >80 |
| Initial input power | 22 W |
| Power consumption tolerance | +/-10% |

Over Time Performance (IEC Compliant)

| | |
|---------------------------|---------|
| Median useful life L70B50 | 40000 h |
|---------------------------|---------|

Application Conditions

| | |
|---------------------------|-------------|
| Ambient temperature range | 0 to +45 °C |
|---------------------------|-------------|

Product Data

| | |
|---------------------------------|------------------------------|
| Order product name | RS271B LED20/840 PSU-E NB WH |
| Order code | 919515810946 |
| Numerator - Quantity Per Pack | 1 |
| Numerator - Packs per outer box | 1 |
| Material Nr. (12NC) | 919515810946 |
| Net Weight (Piece) | 0.900 kg |



Dimensional drawing

Product: MR16 RECESSED
Type: RS271B
Application: Indoor

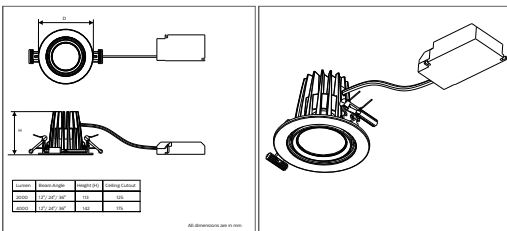

IN9002RDL - Downlights and spots

