



# Greenspace Flex

## RS378B P15 940 PSU-E MB M55

Electronic transformer - - - 30°

GreenSpace Flex is performance portfolio dedicated to Hospitality segment for GC/GM countries. With modular design concept, the light engines and different trims could have multiply of combination to satisfy diversified customer's requirement.

### Product data

General information	
Light source color	940 neutral white
Number of gear units	1 unit
Driver/power unit/transformer	ET [ Electronic transformer]
Driver included	Yes
Optical cover/lens type	No [-]
Luminaire light beam spread	30°
Control interface	-
Connection	CE [ External connector]
Cable	-
Protection class IEC	Safety class II (II)
Glow-wire test	60030 [ Temperature 600 °C, duration 30 s]
CE mark	-
Warranty period	3 years
Constant light output	No
Number of products on MCB of 16 A type B	-
EU RoHS compliant	Yes
Light source engine type	LED

### Operating and electrical

Input Voltage	220 to 240 V
---------------	--------------

Input Frequency	50 or 60 Hz
Average CLO power consumption	1170 W
Power Factor (Min)	0.9

### Controls and dimming

Dimmable	No
----------	----

### Mechanical and housing

Housing Material	Aluminum Alloy
Optic material	Polymethyl methacrylate
Optical cover/lens material	-
Fixation material	Aluminum
Optical cover/lens finish	-
Overall length	0 mm
Overall width	0 mm
Overall height	72 mm
Overall diameter	55 mm
Color	Dark gray
Dimensions (Height x Width x Depth)	72 x 0 x 0 mm

# Greenspace Flex

## Approval and application

Ingress protection code	IP20 [ Finger-protected]
Mech. impact protection code	IK04 [ 0.5 J standard plus]

## Initial performance (IEC compliant)

Initial luminous flux (system flux)	1305 lm
Luminous flux tolerance	+/-10%
Initial LED luminaire efficacy	87 lm/W
Init. Corr. Color Temperature	4000 K
Init. Color Rendering Index	>90
Initial chromaticity	SDCM<3
Initial input power	15 W
Power consumption tolerance	+/-10%

## Over time performance (IEC compliant)

Median useful life L80B50	50000 h
---------------------------	---------

## Application conditions

Ambient temperature range	-20 to +45 °C
Maximum dim level	Not applicable
Suitable for random switching	No

## Product data

Full product code	911401721302
Order product name	RS378B P15 940 PSU-E MB M55
Order code	911401721302
Numerator - Quantity Per Pack	1
Numerator - Packs per outer box	48
Material Nr. (12NC)	911401721302
Net Weight (Piece)	0.260 kg



## Dimensional drawing

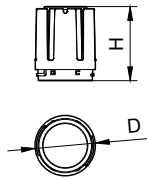

Modular Type	D, mm	H, mm
RS378B P6/P11 M55	55	49
RS378B P15 M55	55	49
RS378B P24 M70	70	90
RS378B P33 M87	87	107
RS378B P42 M102	102	116

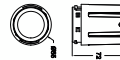

RS378B P15 940 PSU-E MB M55

RS378B P15 940 PSU-E MB M55

