



# Greenspace Flex

## RS378B P6 930 PSU-E WB M55

- ° - 930 warm white - Electronic transformer - Gray

GreenSpace Flex is performance portfolio dedicated to Hospitality segment for GC/GM countries. With modular design concept, the light engines and different trims could have multiply of combination to satisfy diversified customer's requirement.

### Product data

| General Information                      |  |
|--|--|
| Beam angle of light source               | - °  |
| Light source color                       | 930 warm white                             |
| Number of gear units                     | 1 unit                                     |
| Driver/power unit/transformer            | ET [ Electronic transformer]               |
| Driver included                          | Yes  |
| Optic type                               | No [-]                                     |
| Optical cover/lens type                  | Lens                                       |
| Luminaire light beam spread              | 32°  |
| Control interface                        | -  |
| Connection                               | CE [ External connector]                   |
| Cable                                    | -  |
| Protection class IEC                     | Safety class II (II)                       |
| Glow-wire test                           | 60030 [ Temperature 600 °C, duration 30 s] |
| Flammability mark                        | NO [-]                                     |
| CE mark                                  | CE mark                                    |
| ENEC mark                                | -  |
| Warranty period                          | 3 years                                    |
| Constant light output                    | No   |
| Number of products on MCB of 16 A type B | -  |
| EU RoHS compliant                        | Yes  |

| Light source engine type      | LED                     |
|-------------------------------|-------------------------|
| Operating and Electrical      |                         |
| Input Voltage                 | 220 to 240 V            |
| Input Frequency               | 50 to 60 Hz             |
| Average CLO power consumption | 390 W                   |
| Power Factor (Min)            | 0.5                     |
| Controls and Dimming          |                         |
| Dimmable                      | No                      |
| Mechanical and Housing        |                         |
| Housing Material              | Aluminum                |
| Reflector material            | -                       |
| Optic material                | Polymethyl methacrylate |
| Optical cover/lens material   | Acrylate                |
| Fixation material             | Aluminum                |
| Optical cover/lens finish     | Textured                |
| Overall length                | 0 mm                    |
| Overall width                 | 0 mm                    |
| Overall height                | 49 mm                   |

## Greenspace Flex

|                  |       |
|------------------|-------|
| Overall diameter | 55 mm |
| Color            | Gray  |

### Approval and Application

|                              |                             |
|------------------------------|-----------------------------|
| Ingress protection code      | IP20 [ Finger-protected]    |
| Mech. impact protection code | IK04 [ 0.5 J standard plus] |

### Initial Performance (IEC Compliant)

|                                     |         |
|-------------------------------------|---------|
| Initial luminous flux (system flux) | 480 lm  |
| Luminous flux tolerance             | +/-10%  |
| Initial LED luminaire efficacy      | 80 lm/W |
| Init. Corr. Color Temperature       | 3000 K  |
| Init. Color Rendering Index         | >90     |
| Initial chromaticity                | SDCM<3  |
| Initial input power                 | 6 W     |
| Power consumption tolerance         | +/-10%  |

### Over Time Performance (IEC Compliant)

|                           |         |
|---------------------------|---------|
| Median useful life L80B50 | 50000 h |
|---------------------------|---------|

### Application Conditions

|                               |                |
|-------------------------------|----------------|
| Ambient temperature range     | -20 to +45 °C  |
| Maximum dim level             | Not applicable |
| Suitable for random switching | No             |

### Product Data

|                                 |                            |
|---------------------------------|----------------------------|
| Full product code               | 911401720962               |
| Order product name              | RS378B P6 930 PSU-E WB M55 |
| Order code                      | 911401720962               |
| Numerator - Quantity Per Pack   | 1                          |
| Numerator - Packs per outer box | 36                         |
| Material Nr. (12NC)             | 911401720962               |
| Net Weight (Piece)              | 0.180 kg                   |



## Dimensional drawing

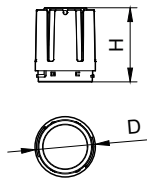

| Modular Type      | D, mm | H, mm |
|-------------------|-------|-------|
| RS378B P6/P11 M55 | 55    | 49    |
| RS378B P15 M55    | 55    | 49    |
| RS378B P24 M70    | 70    | 90    |
| RS378B P33 M87    | 87    | 107   |
| RS378B P42 M102   | 102   | 116   |

### RS010 Spot RS010B-RS019B

